

Project Owner:	Hudsonville Public Schools
Project Name:	Hudsonville HS Clock & PA Improvements
Issue Date:	February 22, 2024

ADDENDUM NO. 1

This Addendum No. 1 of the Technology Request for Bid for the above referenced project hereby amends, supplements and/or augments all prior issued document(s) as described herein, and becomes an inseparable part of the Contract Documents, superseding all previous, contrary and/or conflicting information.

AD1 - 1	Division 27 Drawings are hereby revised, reissued and attached hereto. Note: Addendum item changes are marked with a callout of "Addendum 1".
----------------	--

END OF ADDENDUM NO. 1

<i>Bid ID: 3040</i>	Communications by Design, Inc.
<i>Addendum #1 Issued: March 8, 2024</i>	<i>Proprietary Information – All Rights Reserved</i>

ADDENDUM 1

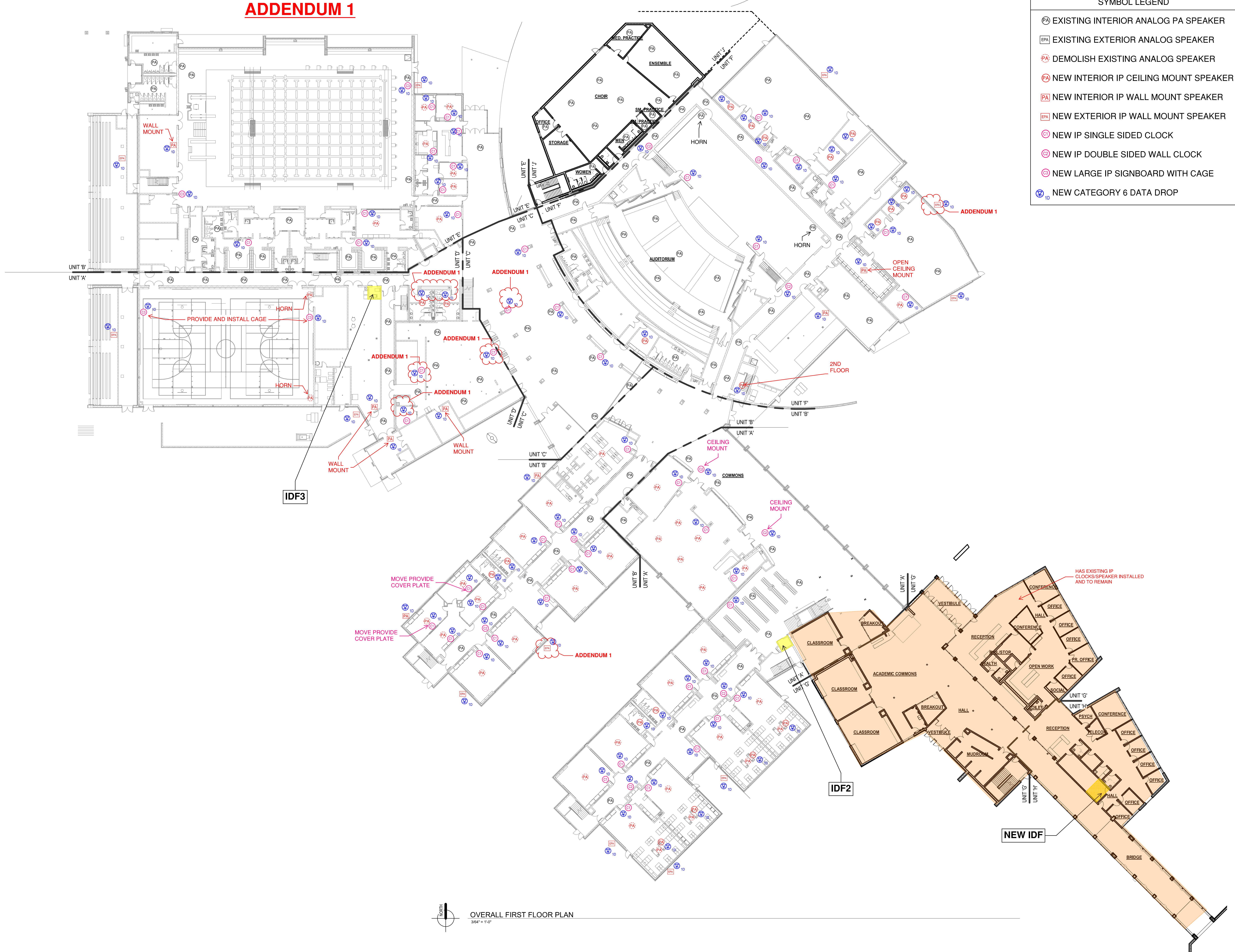

SYMBOL LEGEND	
	EXISTING INTERIOR ANALOG PA SPEAKER
	EXISTING EXTERIOR ANALOG SPEAKER
	DEMOLISH EXISTING ANALOG SPEAKER
	NEW INTERIOR IP CEILING MOUNT SPEAKER
	NEW INTERIOR IP WALL MOUNT SPEAKER
	NEW EXTERIOR IP WALL MOUNT SPEAKER
	NEW IP SINGLE SIDED CLOCK
	NEW IP DOUBLE SIDED WALL CLOCK
	NEW LARGE IP SIGNBOARD WITH CAGE
	NEW CATEGORY 6 DATA DROP

ISSUANCES	DATE:
ISSUED	DATE: 02/22/2024
ADDENDUM 1	DATE: 03/08/2024

DRAWN	INITIALS C.J.M.
REVIEWED	INITIALS C.J.M.

PROJECT NO. 3040

FIRST FLOOR PLAN - HIGH SCHOOL/FRESHMAN CENTER

Division 27 – Low Voltage Cabling, Public Address System and Clock System Drawings

ADDENDUM 1

MDF AND PA
HEADEND



HUDSONVILLE PUBLIC SCHOOLS IP CLOCK AND PUBLIC ADDRESS IMPROVEMENTS 2024

HUDSONVILLE PUBLIC SCHOOLS

HUDSONVILLE
MICHIGAN

ISSUANCES	DATE:
ISSUED	DATE: 02/22/2024
ADDENDUM 1	DATE: 03/08/2024

DRAWN	INITIALS CJM
REVIEWED	INITIALS CJM

PROJECT NO.	3040
SECOND FLOOR PLAN - HIGH SCHOOL/FRESHMAN CENTER	

Division 27 – Low Voltage Cabling, Public Address System and Clock System Drawings

DROP
CEILING

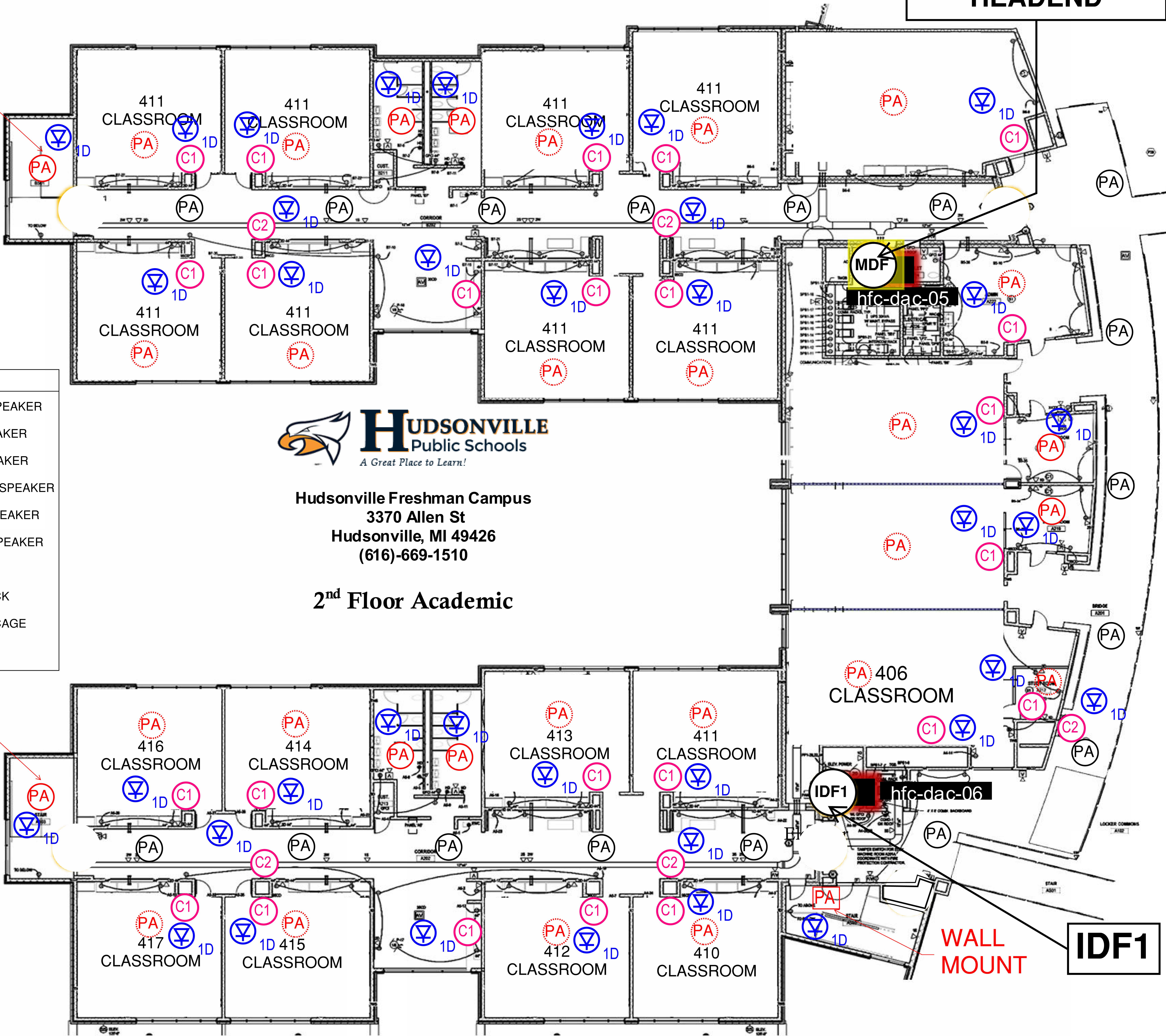

Hudsonville Freshman Campus
3370 Allen St
Hudsonville, MI 49426
(616)-669-1510

2nd Floor Academic

DROP
CEILING

WALL
MOUNT

IDF1

SYMBOL LEGEND	
	EXISTING INTERIOR ANALOG PA SPEAKER
	EXISTING EXTERIOR ANALOG SPEAKER
	DEMOLISH EXISTING ANALOG SPEAKER
	NEW INTERIOR IP CEILING MOUNT SPEAKER
	NEW INTERIOR IP WALL MOUNT SPEAKER
	NEW EXTERIOR IP WALL MOUNT SPEAKER
	NEW IP SINGLE SIDED CLOCK
	NEW IP DOUBLE SIDED WALL CLOCK
	NEW LARGE IP SIGNBOARD WITH CAGE
	NEW CATEGORY 6 DATA DROP

ADDENDUM 1

SYMBOL LEGEND	
	EXISTING INTERIOR ANALOG PA SPEAKER
	EXISTING EXTERIOR ANALOG SPEAKER
	DEMOLISH EXISTING ANALOG SPEAKER
	NEW INTERIOR IP CEILING MOUNT SPEAKER
	NEW INTERIOR IP WALL MOUNT SPEAKER
	NEW EXTERIOR IP WALL MOUNT SPEAKER
	NEW IP SINGLE SIDED CLOCK
	NEW IP DOUBLE SIDED WALL CLOCK
	NEW LARGE IP SIGNBOARD WITH CAGE
	NEW CATEGORY 6 DATA DROP

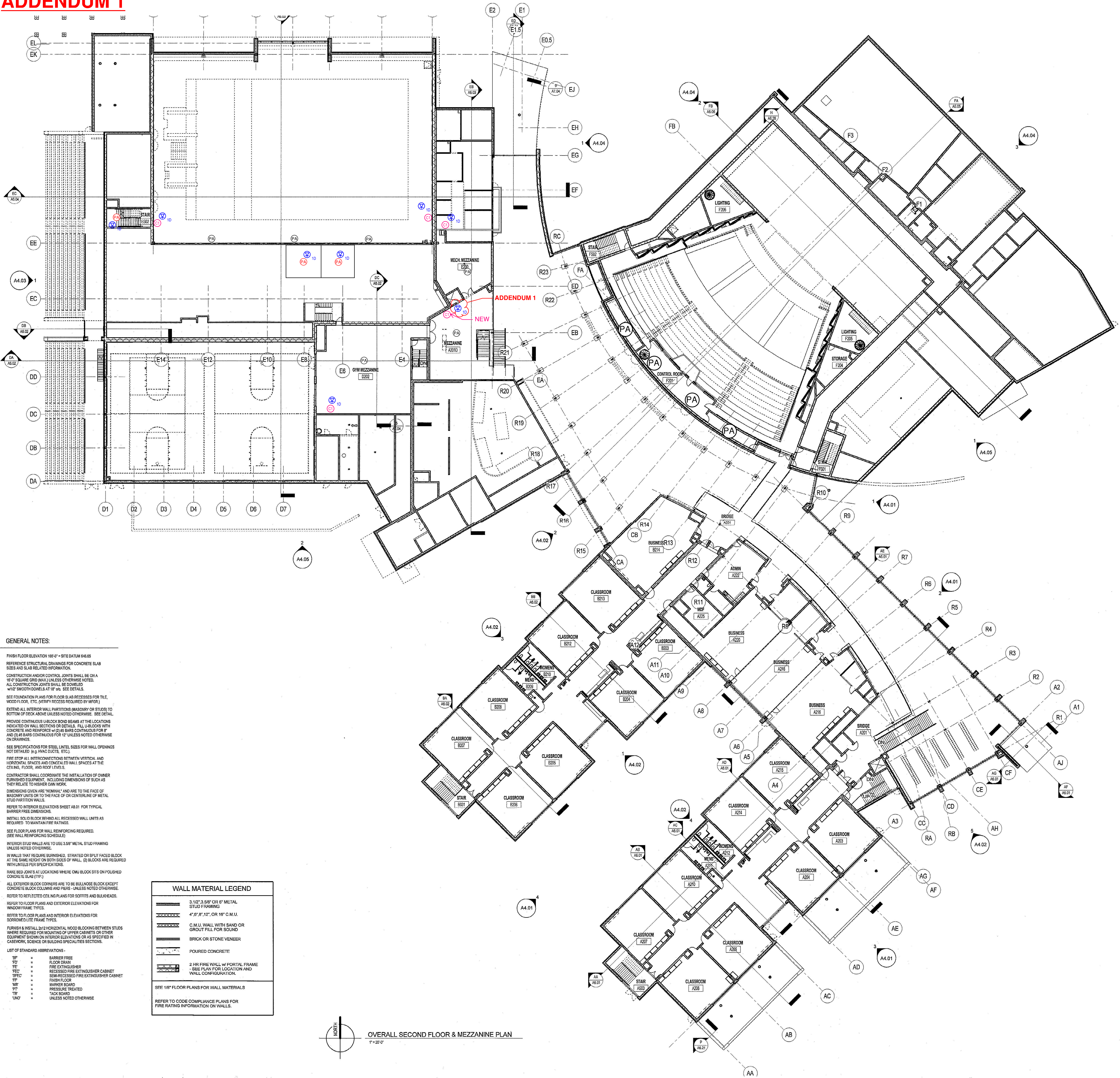

WALL REINFORCING SCHEDULE				
MARK	NUMBER OF BARS	BAR SIZE (GRADE #)	BAR SPACING	REMARKS
R1-5-48	ONE	#5	48" o.c.	CENTER IN CORE
R2-5-32	TWO	#5	32" o.c.	CENTER IN CORE
NOTE: MINIMUM REINFORCING (FOR ALL WALLS NOT OTHERWISE NOTED): ALL BEARING WALLS SHALL RECEIVE A MINIMUM REINFORCING OF R1-5-48. ALL EXTERIOR WALLS SHALL RECEIVE A MINIMUM REINFORCING OF R1-5-48. ALL INTERIOR NON-BEARING WALLS OVER 10'-0" HIGH SHALL RECEIVE A MINIMUM REINFORCING OF R1-5-48. ALL MASONRY PIERS SHALL RECEIVE A MINIMUM REINFORCING OF (4) #5 BARS FULL HEIGHT IN GROUTED CORES. ALL BAR LAPS ARE TO BE 30" MINIMUM. BLOCK CORES WITH VERTICAL REINFORCING SHALL BE GROUTED SOLID FOR FULL HEIGHT OF WALL. 16" CMU MASONRY WALL MUST BE 16" CMU (NOT 20SP) VERTICAL REINFORCING SHALL BE REQUIRED ON BOTH SIDES OF ALL WALL OPENINGS. ALL BEARING AND EXTERIOR WALLS NOT OTHERWISE NOTED SHALL RECEIVE A MINIMUM WALL REINFORCING OF R1-5-48. (SEE PLANS) WHEN A FOUNDATION DOWEL DOES NOT LINE UP WITH A VERTICAL BLOCK CORREL, IT SHALL NOT BE SLOPED MORE THAN ONE HORIZONTAL IN 5 VERTICAL. DOWELS MAY BE GROUTED INTO A CELL ADJACENT TO THE VERTICAL WALL REINFORCING. SAND FILL ALL BLOCK WALLS AT TOILET ROOMS DIRECTLY ADJACENT TO CLASSROOMS.				
<p>ONE BAR DIA. MIN. CLEARANCE 3/4" MIN. CLEARANCE FROM MASONRY (TYP. ALL SIDES) TWO BAR PLAN ONE BAR PLAN ALIGN CORES VERTICALLY TO MAINTAIN A CONTINUOUS UNOBSTRUCTED 3' x 4' CELL AREA - GROUT SOLID FOR FULL HEIGHT OF WALL WALL REINFORCING DETAIL CONC. MASONRY UNITS</p>				

GENERAL NOTES:

1. FINISH FLOOR ELEVATION 100'-0" - SITE DATUM 646.65
2. REFERENCE STRUCTURAL DRAWINGS FOR CONCRETE SLAB SIZES AND SLAB RELATED INFORMATION.
3. CONSTRUCTION AND/OR CONTROL JOINTS SHALL BE ON A 16'-0" SQUARE GRID (MAX) UNLESS OTHERWISE NOTED. ALL CONSTRUCTION JOINTS SHALL BE COMPLETED WITH SMOOTH DOWELS AT 18" o.c. SEE DETAILS.
4. SEE FOUNDATION PLANS FOR FLOOR SLAB RECESSES FOR TILE, WOOD FLOORS, ETC. (VERIFY RECESSES REQUIRED BY WORK).
5. EXTEND ALL INTERIOR WALL PARTITIONS (MASONRY OR STUDS) TO BOTTOM OF DECK ABOVE UNLESS NOTED OTHERWISE. SEE DETAIL.
6. PROVIDE CONTINUOUS UNBLOCKED BOND BEHIND ALL LOCATIONS INDICATED ON WALL SECTIONS OR DETAILS. FILL BLOCKS WITH CONCRETE AND REINFORCE WITH #5 BARS CONTINUOUS FOR 8" AND #5 BARS CONTINUOUS FOR 12" UNLESS NOTED OTHERWISE ON DRAWINGS.
7. SEE SPECIFICATIONS FOR STEEL LATEL SIZES FOR WALL OPENINGS NOT DETAILLED (e.g. HVAC DUCTS, ETC.).
8. FIRE STOP ALL INTERCONNECTIONS BETWEEN VERTICAL AND HORIZONTAL SPACES AND CONICAL TO WALL SPACES AT THE CEILING, FLOOR, AND ROOF LEVELS.
9. CONTRACTOR SHALL COORDINATE THE INSTALLATION OF OWNER FURNISHED EQUIPMENT, INCLUDING DIMENSIONS OF SUCH AS THEY RELATE TO HISHER OWN WORK.
10. DIMENSIONS GIVEN ARE "NOMINAL" AND ARE TO THE FACE OF MASONRY UNITS OR TO THE FACE OF OR CENTERLINE OF METAL STUD PARTITION WALLS.
11. REFER TO INTERIOR ELEVATIONS SHEET A8.01 FOR TYPICAL BARRIER FREE DIMENSIONS.
12. INSTALL SOLID BLOCK BEHIND ALL RECESSED WALL UNITS AS REQUIRED TO MAINTAIN FIRE RATING.
13. SEE FLOOR PLANS FOR WALL REINFORCING REQUIRED. (SEE WALL REINFORCING SCHEDULE).
14. INTERIOR STUD WALLS ARE TO USE 3.5SP METAL STUD FRAMING UNLESS NOTED OTHERWISE.
15. IN WALLS THAT REQUIRE BURNISHED, STRIATED OR SPLIT FACED BLOCK AT THE SAME HEIGHT ON BOTH SIDES OF WALL, (2) BLOCKS ARE REQUIRED WITH UNLESS SPECIFICALLY NOTED.
16. RAISE BED JOINTS AT LOCATIONS WHERE CMU BLOCK SITS ON POLISHED CONCRETE SLAB (TYP.).
17. ALL EXTERIOR BLOCK CORNERS ARE TO BE BURNISHED BLOCK EXCEPT CONCRETE BLOCK CORNERS AND PERS - UNLESS NOTED OTHERWISE.
18. REFER TO REFLECTED CEILING PLANS FOR SOFFITS AND BULKHEADS.
19. REFER TO FLOOR PLANS AND EXTERIOR ELEVATIONS FOR WINDOW FRAME TYPES.
20. REFER TO FLOOR PLANS AND INTERIOR ELEVATIONS FOR BURNISHED LIFE FRAME TYPES.
21. FURNISH & INSTALL 2X12 HORIZONTAL WOOD BLOCKING BETWEEN STUDS WHERE REQUIRED FOR MOUNTING OF UPPER CABINETS OR OTHER EQUIPMENT SHOWN ON INTERIOR ELEVATIONS OR AS SPECIFIED IN CADDENING, SCHEMATIC OR BUILDING SPECIALTIES SECTIONS.
22. LIST OF STANDARD ABBREVIATIONS:
3" = BARRIER FREE
FD = FLOOR DRAIN
FC = FIRE EXTINGUISHER
YEC = RECESSED FIRE EXTINGUISHER CABINET
SE = SEMI RECESSED FIRE EXTINGUISHER CABINET
FF = FINISH FLOOR
MWP = MASONRY WALL PIER
PT = PRESSURE TREATED
TP = TACK BOARD
UND = UNLESS NOTED OTHERWISE

WALL MATERIAL LEGEND

	3.12\"/>
	4\"/>
	C.M.U. WALL WITH SAND OR GROUT FILL FOR SOUND
	BRICK OR STONE VENEER
	POURED CONCRETE
SEE 1/8\"/>	
REFER TO CODE COMPLIANCE PLANS FOR FIRE RATING INFORMATION ON WALLS.	

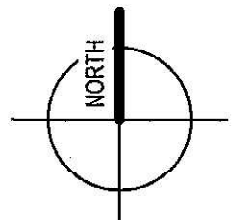

OVERALL SECOND FLOOR & MEZZANINE PLAN

1\"/>

ISSUANCES	DATE
ISSUED	DATE: 02/22/2024
ADDENDUM 1	DATE: 03/08/2024

DRAWN	INITIALS C.J.M.
REVIEWED	INITIALS C.J.M.

PROJECT NO.	3040
SECOND FLOOR ATHLETICS PLAN - HIGH SCHOOL/FRESHMAN CENTER	

Division 27 - Low Voltage Cabling, Public Address System and Clock System Drawings

ADDENDUM 1

SYMBOL LEGEND

 EXISTING INTERIOR ANALOG PA SPEAKER

 EXISTING EXTERIOR ANALOG SPEAKER

 DEMOLISH EXISTING ANALOG SPEAKER

 NEW INTERIOR IP CEILING MOUNT SPEAKER

 NEW INTERIOR IP WALL MOUNT SPEAKER

 NEW EXTERIOR IP WALL MOUNT SPEAKER

 NEW IP SINGLE SIDED CLOCK

 NEW IP DOUBLE SIDED WALL CLOCK

 NEW LARGE IP SIGNBOARD WITH CAGE

 NEW CATEGORY 6 DATA DROP

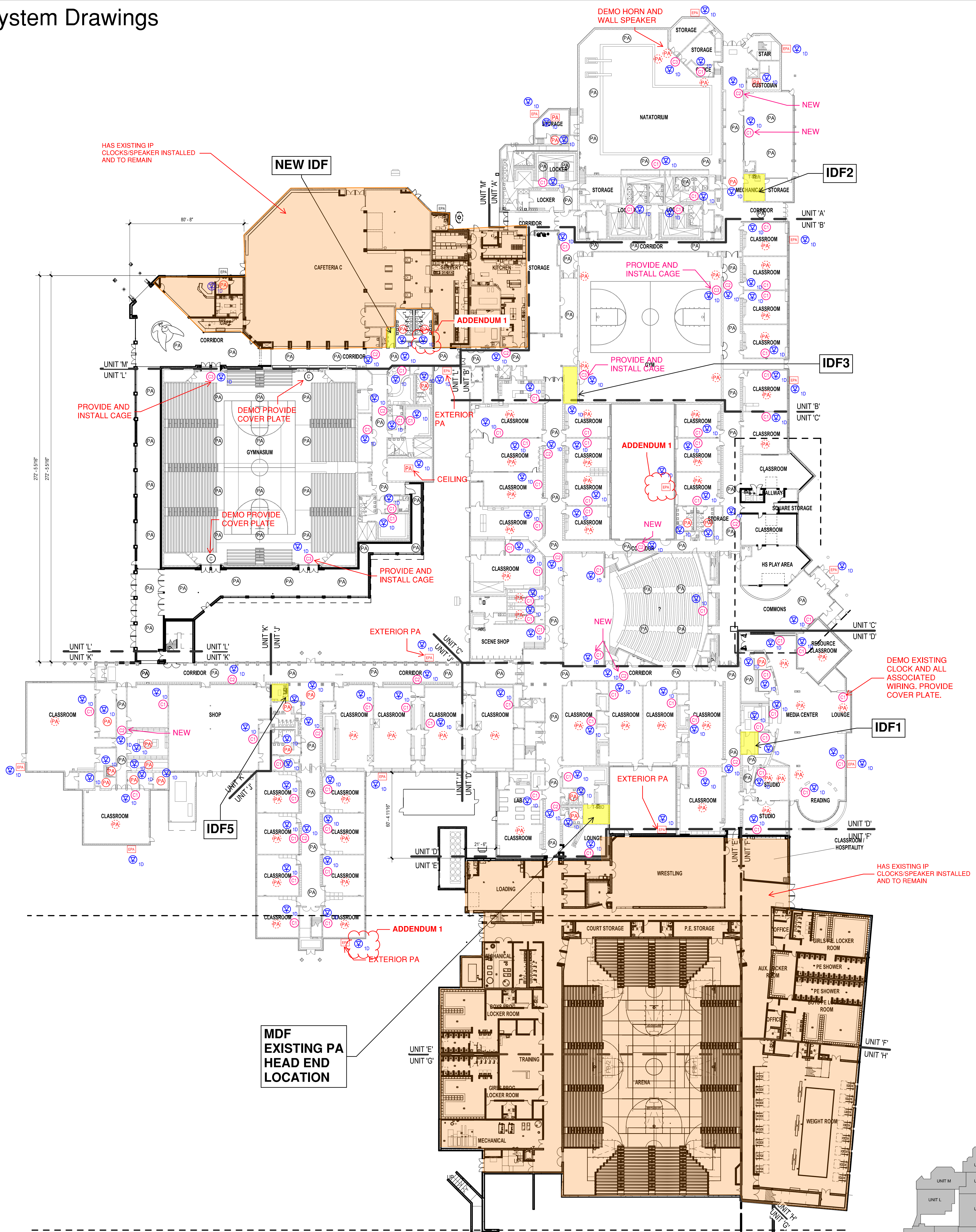











ISSUANCES	DATE:
ISSUED	DATE: 02/22/2024
ADDENDUM 1	DATE: 03/08/2024

DRAWN	INITIALS C.J.M.
REVIEWED	INITIALS C.J.M.

PROJECT NO.	3040
FIRST FLOOR PLAN - HIGH SCHOOL	

Division 27 – Low Voltage Cabling, Public Address System and Clock System Drawings

ADDENDUM 1

SYMBOL LEGEND	
	EXISTING INTERIOR ANALOG PA SPEAKER
	EXISTING EXTERIOR ANALOG SPEAKER
	DEMOLISH EXISTING ANALOG SPEAKER
	NEW INTERIOR IP CEILING MOUNT SPEAKER
	NEW INTERIOR IP WALL MOUNT SPEAKER
	NEW EXTERIOR IP WALL MOUNT SPEAKER
	NEW IP SINGLE SIDED CLOCK
	NEW IP DOUBLE SIDED WALL CLOCK
	NEW LARGE IP SIGNBOARD WITH CAGE
	NEW CATEGORY 6 DATA DROP

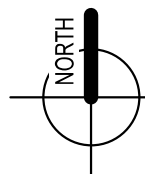
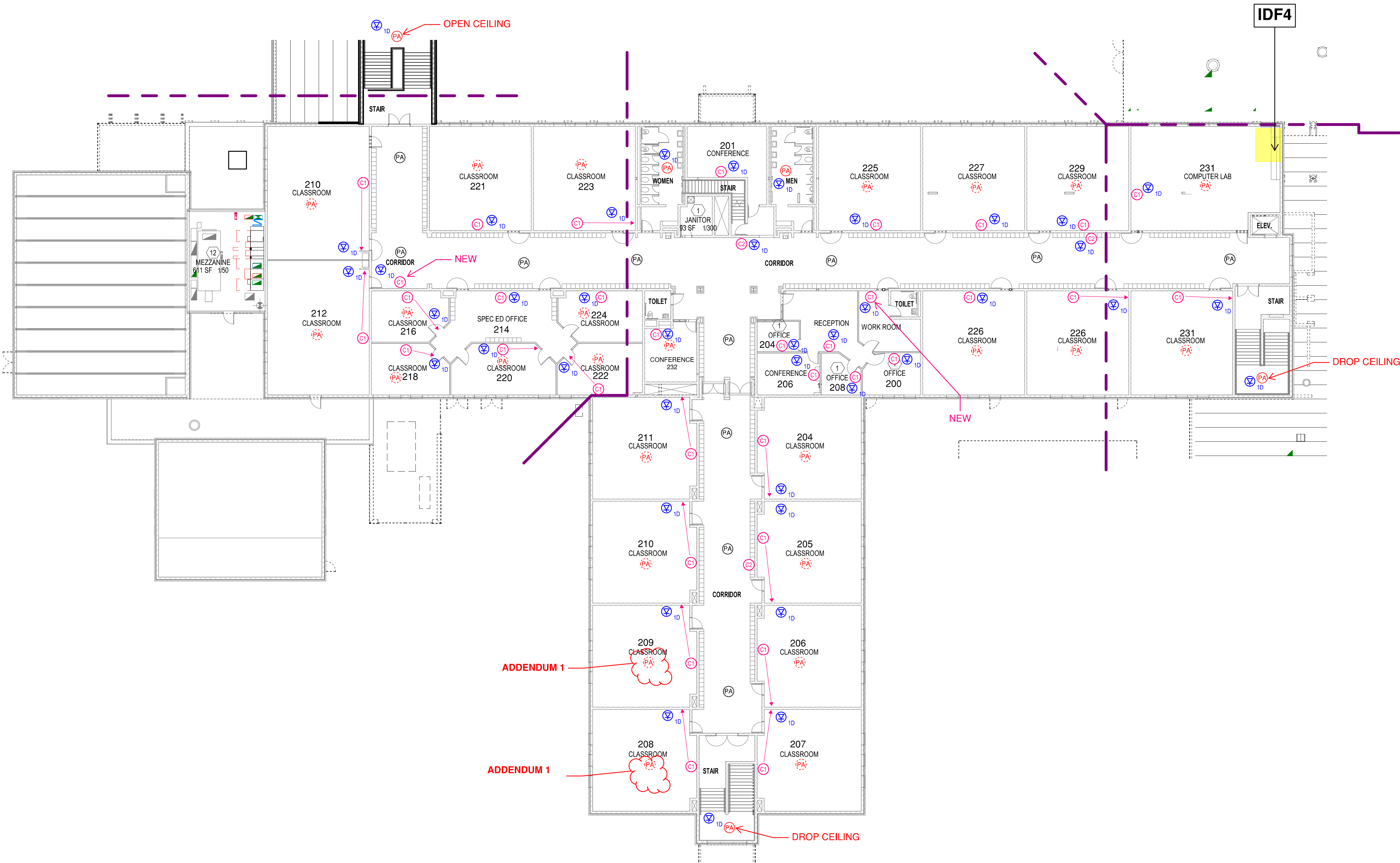

HS - SECOND FLOOR CODE COMPLIANCE PLAN - WEST
1/16" = 1'-0"

ISSUANCES	DATE:
ISSUED	DATE: 02/22/2024
ADDENDUM 1	DATE: 03/08/2024

DRAWN	INITIALS CJM
REVIEWED	INITIALS CJM

PROJECT NO.	3040
SECOND FLOOR PLAN - HIGH SCHOOL	

Division 27 – Low Voltage Cabling, Public
Address System and Clock System
Drawings